

### LED-0108

LED Message Screen



### LED-0110

LED Message Sign



### LED-0105

LED Message Screen



#### SPECIFICATION(LED-0108):

- Message Board size: 1074x148x36mm
- Stand flashing display for a word less than 10 letters
- Scrolling display for a word over than 10 letters
- Moving display of directional arrow from left side to right side, or from right side to left sides, or from center to both sides
- Mini keyboards and LCD screen for easy operation

#### SPECIFICATION(LED-0110/LED-0105):

- Life Span: 100,000 12/24V
- Adopt G-II 0.25W LED's
- SIZE : 350(L)x36(W)x130(H)mm(LED-0110)
- SIZE : 580(L)x40(W)x105(H)mm(LED-0105)
- Net Weight: 2KGS(LED-0110)
- Net Weight: 2.5 KGS(LED-0105)

### LTF5850 LED Message Light Bar



### LTF5950 LED Message Light Bar



#### SPECIFICATION(LED5850):

This product adopts double-layer aluminum alloy boards structure and sector design, which has distinct outline stronger percussion-resistant capability, and is not easy to lose color and get aged. Moreover, the caution light has good sealing and water-proof. Several LED lights are distributed as a ring and give out strong flash from each direction. On the back of it, there has a English display screen on it, Even in extremely complicated, circumstances, it can transmit emergency signal correctly.

- The rated work voltage: DC12V/24V
- The length of the light: 1.16m.
- The max. lightened bound: > 800LX.
- The environment temperature: -40 degree ~ +50 degree
- Waste current: <11A

#### SPECIFICATION(LED5950):

This product adopts double-layer aluminum alloy boards structure and sector design, which has distinct outline stronger percussion-resistant capability, and is not easy to lose color and get aged. Moreover, the caution light has good sealing and water-proof. Several LED lights are distributed as a ring and give out strong flash from each direction. On the back and front, there have two English display screens, Even in extremely complicated, circumstances, it can transmit emergency signal correctly.

- The rated work voltage: DC12V/24V
- The length of the light: 1.16m.
- The max. lightened bound: > 800LX.
- The environment temperature: -40 degree ~ +50 degree
- Waste current: <12A

### LTE317

Strong Strobe Light



### LTE327

Strong Strobe Light



#### SPECIFICATION:

- Bulbs adopt pulse xenon strobes working with multi-flash.
- It can be installed in front and rear of the vehicle and fitted out with motorcycle
- It can be permanently or magnetically mounted

- Bulb : Germany imported bulb or domestic bulbs
- Power : 70 W
- Impedance : 4 ohm or 8 ohm(LTE317)
- Dome Color :Red/Blue/White

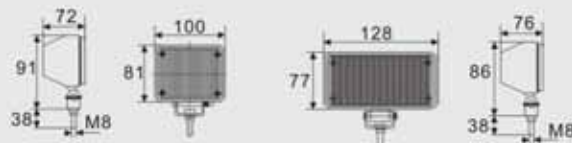

## LTE327A

Strong Strobe Light

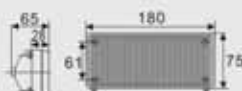

LTE327A

## LTE337F

Strong Strobe Light



LTE337F

## LTE317 LED Light

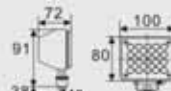

LTE317 LED

## LED327B

Strong LED Light

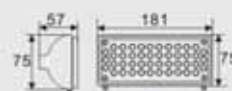

LED327B

### SPECIFICATION(LTE327A/LTF337F):

- Bulbs adopt pulse xenon strobes working with multi-flash
- It can be installed in front and rear of the vehicle and fitted out with motorcycle
- It can be permanently or magnetically mounted
- Bulb : Germany imported bulb or domestic bulbs
- Power : 70W
- Dome Color : Red/Blue/White

### SPECIFICATION(LTE317 LED/LED327B):

- Bulbs adopt LED working with multi-flash(LED327B:7 kinds of Flash patterns)
- It can be installed in front and rear of the vehicle and fitted out with motorcycle
- It can be permanently or magnetically mounted
- Power : 70 W(LTE317); Power:25W(LED327B)
- Bulb:LED bulbs; Dome Color : Red/Blue/White

## LED337B

Super LED strobe kits



## LED337D

Super LED strobe kits



## LED337E

Super LED strobe kits



## LED347B

LED Hide-A-Way Kits



## LED347D

LED Hide-A-Way Kits



## LED347E

LED Hide-A-Way Kits

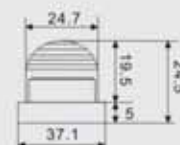
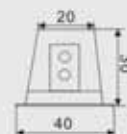

## LED337A

Super LED Strobe Kits



## LED347

Super LED Hide-A-Way Light



### SPECIFICATION(LED337A/LED337B/LED337D/LED337E):

- Voltage : DC 12/24V
- Electric Current : less than 1.2A
- Life Span: 100,000
- G-3 LEDs with 8 bulbs(LED337A);
- G-3 LEDs with 16 bulbs(LED337B);
- G-3 LEDs with 32 bulbs(LED337D);
- G-3 LEDs with 48 bulbs(LED337E)
- 4 flash patters to pick up and can flash two lightheds together for synchronization .
- Perfect for rearview mirror, rear deck

### SPECIFICATION(LED347/347B/LED347D/LED347E):

- Powered by DC12V or DC24V
- 15 Flash Patterns and Generation 3 LEDs
- 6 1-watt LEDs per bulb;Push bulb installation
- 1PCS LED Head, 1PCS Cable, 1PC Power Wire with Mode Switch(LED347)
- 2PCS LED Head, 2PCS Cable, 1PC Power Wire with Mode Switch(LED347B)
- 4PCS LED Head, 4PCS Cable, 1PC Power Wire with Mode Switch(LED347D)
- 6PCS LED Head, 6PCS Cable, 1PC Power Wire with Mode Switch(LED347E)
- Available in Amber,Clear,Green,Red and Blue Colors



### LTE337A

Strong Strobe Light



### LTE337B

Strong Strobe Light



### LTE337C

Strong Strobe Light



### LTE437 Strobe Light



### LTE637 Strobe Light



### LTE837 Strobe Light



### LTE207

Waterproof Strobe Light



### LTE407

Waterproof Strobe Light



### LTE607

Waterproof Strobe Light



#### SPECIFICATION(LTE337A/LTE337B/LTE337C):

- Bulbs adopt strobe bulbs working with multi-flash.
- It can be installed in front and rear of the vehicle and fitted out with motorcycle.
- It can be permanently or magnetically mounted.
- Bulb : Germany Imported bulbs or Domestic bulbs
- Power: 70W

#### SPECIFICATION(LTE437):

- Output Power: 80W
- Voltage: DC12V
- Power supply dimensions: 140\*11\*45mm
- All of aluminium installation without any radiator.
- Imitating US Federal and main parts are from Germany
- It has 4 flash patterns which controlled by a small controller
- Includes 1 Strobe set, 2 15-foot extension cables, 2 10-foot Extension cables, and 4 Clear strobe Replacement lighthead

#### SPECIFICATION(LTE637):

- Output power: 120W
- Voltage: DC12V
- 6 flash patterns and push Bulb installation
- Power supply dimensions: 165\* 114\*50mm
- Includes 6 bulbs ;2 sets of 16-foot cable ; 4 sets of 8-foot cable;Grand Control with auxiliary output;Includes a built in dash mounted switch for ON/OFF function and flash patterns

#### SPECIFICATION(LTE837):

- Working voltage: DC12V(range DC11-14V)
- Rated power: 20W\*8PCs
- Overall size: 174.5\*148.5\*52mm
- Ambient temperature: - 40 degree~+50 degree
- Flash frequency: 15 patterns

#### SPECIFICATION(LTE207):

- Voltage: 12 VDC

- Input current: 1.1amps
- 2 hide a way strobe bulbs
- 3 pin male female connectors
- 2 ten feet cables
- Dimensions of bulb: 25.4 mm with 38mm base
- Dimensions of power supply: 127mmL\*114mmW\*50mm H
- Fully encapsulated driver allows for water and weather damage protection

#### SPECIFICATION(LTE407):

- 4 flash patterns
- Voltage: 12 VDC
- Power:90W
- Input current: 2.2amps
- 4 hide a way strobe bulbs
- 3 pin male female connectors
- 2 ten feet cables, 2 fifteen feet cables
- Dimensions of bulb: 25.4 mm with 38mm base
- Dimensions of power supply: 127mmL\*114mmW\*50mm H
- Fully encapsulated driver allows for water and weather damage protection

#### SPECIFICATION(LTE607):

- 4 flash patterns
- Voltage: 12 VDC
- Power:120W
- Input current: 3.6amps
- Input current: 2.2amps
- 6 hide a way strobe bulbs
- 3 pin male female connectors
- 4 ten feet cables, 2 fifteen feet cables
- Dimensions of bulb: 25.4 mm with 38mm base

### LED307-6

Hide-a-way LED

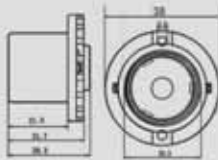

### LED307-12

Hide-a-way LED

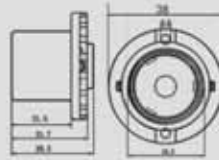

### LED387

Hide-a-way LED

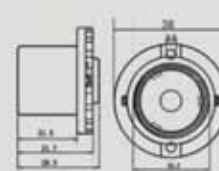

### LED367

Hide-a-way LED



### LED367B

Hide-a-way LED



### LTE397 LED Light

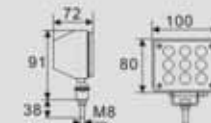

#### SPECIFICATION(LED307-6/LED307-12):

- Powered by DC10-30V
- 6 X 1-watt LEDs per bulb with 360° optics inside (LED307-6)
- 12 X 1-watt LEDs per bulb with 360° optics inside (LED307-12)
- Completely Waterproof
- Generation 3 LEDs
- 19 Flash Patterns and Inline flasher
- Mounts in a 1 inch hole
- Constructed with heavy duty gauge cables
- Split and Solid Alternating Flash Patterns
- Red=Positive Black=Negative Yellow =Pattern Switch and SYNC Blue= Alternating
- The optic design produces 360°light dispersion and maximizes secondary light output reflected off the vehicle light casing .

#### SPECIFICATION(LED387/LED367/LED367B):

- Powered by DC10-30V
- 8 X 1-watt LEDs per bulb (LED387)
- 9 X 1-watt LEDs per bulb (LED367/LED367B)
- Constructed with heavy duty gauge cables

- Mounts in a 1 inch hole
- Generation 3 LEDs
- Completely Waterproof
- Split and Solid Alternating Flash Patterns
- 19 Flash Patterns and Inline flasher
- Red=Positive Black=Negative Yellow =Pattern Switch and SYNC Blue= Alternating(LED387/LED367)
- Red--Power(DC10-30V) Black--Ground Yellow-- SYNC Blue--Pattern switch (LED367B)

#### SPECIFICATION(LED397)

- Work voltage:DC12V/24V
- PC Lens
- LED bulbs, energy saving, low consumption, environmental protection
- Waterproof and shakeproof
- Power supply way:Constant voltage current control
- Colors available: Blue or red, White, Amber colors
- It is used for Police and fire, and Emergency vehicle and so on.

### LED357 Hide-a-way LED



#### SPECIFICATION(LED357):

- Voltage: 10-30 VDC
- 15 flash patterns
- 12PCS 1W LEDs per lighthouse
- Includes 6 feet of cable
- Includes surface mount flange
- Dual/Multi-color options available
- Inline driver allows for simple installation
- Lens designed for optimal light distribution

- Dimensions of bulb: 1" H with 1.5" diameter base
- Aluminum base with advanced thermal management
- Capable of synchronizing and alternating with multiple light heads
- It is used for Police and fire, and Emergency vehicle and so on.